

REV.	DESCRIPTION	DATE	DRAFTER	APPROVER
A1	DWG.REL	2020.05.20	LiuZH	JIN

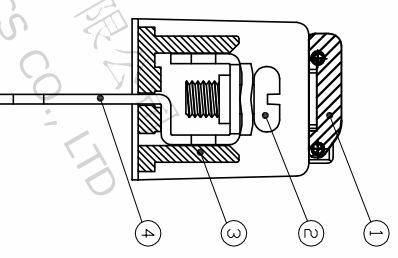

- Material
  - Cover : PC
  - Screws : M3.0 steel, Ni plated
  - Housing : PA66,UL94V-0
  - Terminal : Brass, Tin plated
- Electrical
  - UL IEC
  - Rated voltage : 300V 250V
  - Rated current : 15A 24A
  - Contact resistance : 20mΩ(Max)
  - Insulation resistance : 500MΩ/DC500V
  - Withstanding Voltage : AC2000V/1min
  - Wire range : 22-14AWG 2.5mm<sup>2</sup>
- Mechanical
  - Operating temperature: -40°C ~ +105°C
  - Soldering temperature: 250°C ±5 / 5sec
  - Torque: 0.5N.m (4.43Lb.in)
- RoHS compliance

HOW TO ORDER  
 KF-25HM-7.62-XXP-1 X-XXXXX

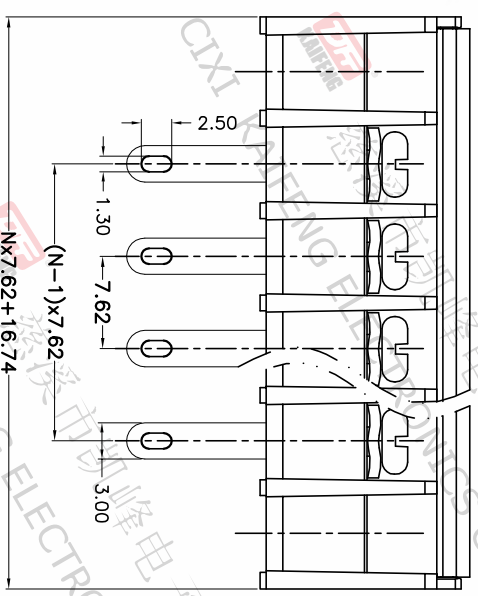
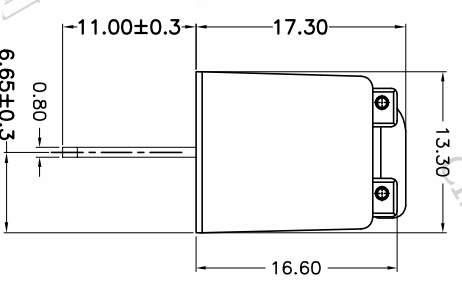
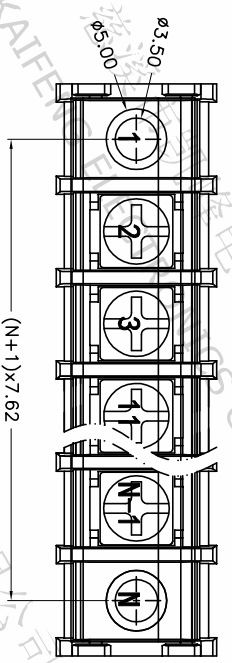
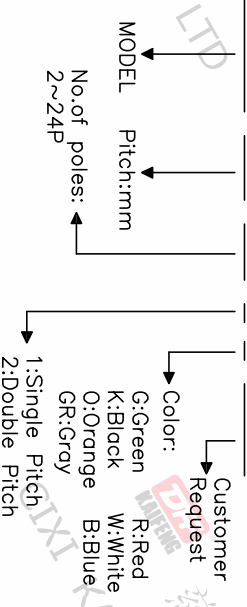

P.C.B.LAYOUT

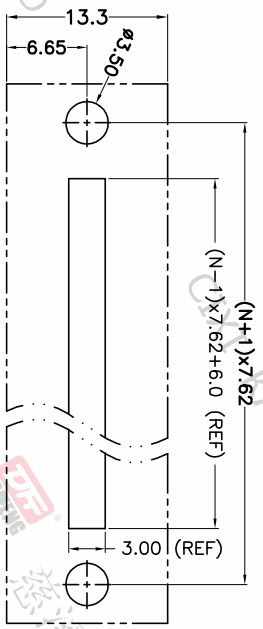

Pitch range	Nominal dimension range	0.1/10	PROJECTION	UNIT	TITLE						
>0	>6	>10	>0	>30	>60	>100	>150	±2°	1:1	SHEET	1 OF 1
~	~	~	~	~	~	~	~	~	~	~	~
6	10	24	30	60	100	150	>150	±2°	1:1	SHEET	1 OF 1
±0.15	±0.20	±0.30	±0.30	±0.50	±0.70	±1.00	±1.30	±2°	1:1	SHEET	1 OF 1

**DF** 慈溪市凯峰电子有限公司  
 CIXI KAIFENG ELECTRONICS CO.,LTD

PROJECT NO. W12000522

SHEET SIZE A4

SERIES KF-25HM

SCALE 1:1

DRAWING TYPE CUSTOMER DRAWING