

REV.	DESCRIPTION	DATE	DRAFTER	APPROVER
A1	DWG.REL	2020/11/2	ZHANG	JIN

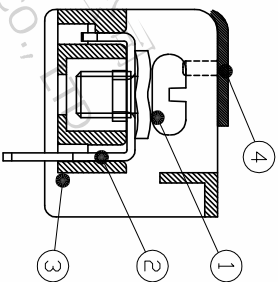
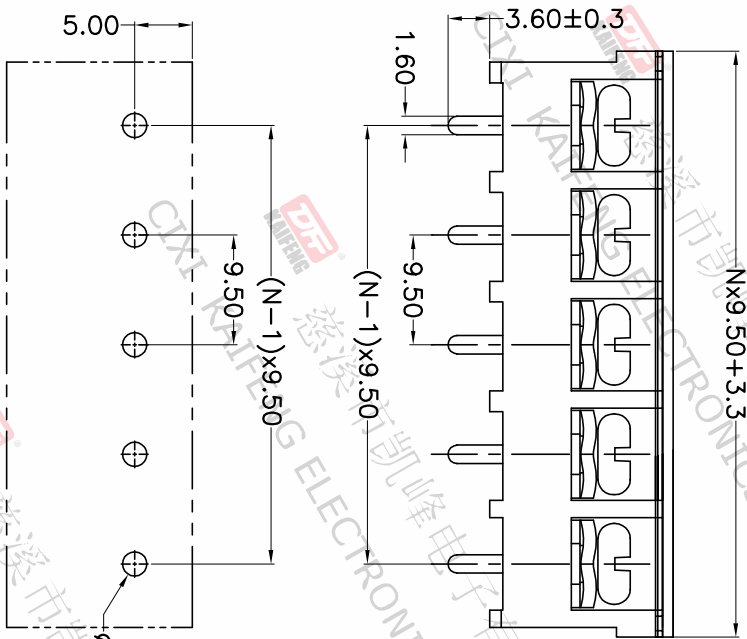
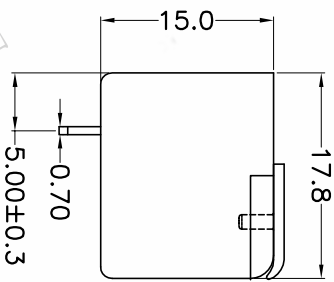
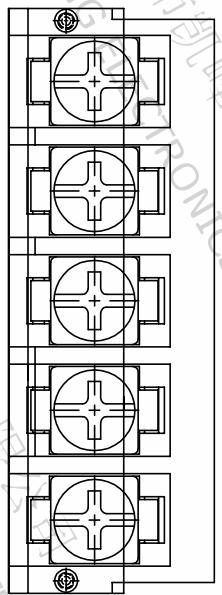

P.C.B.LAYOUT

Pitch range	Nominal dimension range	PROJECTION
>0	>0	0.1/10
~6	~30	≤
~10	~60	≤
~24	~100	≤
~30	~150	≤
±0.15	±0.30	±2°
±0.20	±0.50	
±0.30	±0.70	
±0.50	±1.00	
±1.00	±1.30	

DRAWING TYPE	CUSTOMER DRAWING	SHEET	1 OF 1
SCALE	1:1	SHEET	1 OF 1
DRAWING NO.	W12001442		

- Material
 - ①Cover : PC
 - ②Screws : M4.0 steel, Ni plated
 - ③Housing : PA66,UL94V-0
 - ④Terminal : Brass, Tin plated
- Electrical
 - UL IEC
 - Rated voltage : 300V 750V
 - Rated current : 25A 32A
 - Contact resistance : 20mΩ(Max)
 - Insulation resistance: 500MΩ/DC500V
 - Withstanding Voltage : AC2000V/1min
 - Wire range: 22-12AWG 4.0mm²
- Mechanical
 - Operating temperature: -40℃~+105℃
 - Soldering temperature:250℃±5/5sec
 - Torque: 1.2N.m (10.53Lb.in)
- RoHS compliance

HOW TO ORDER
HB-951M-9.5-XXP-1 X-XXXXX

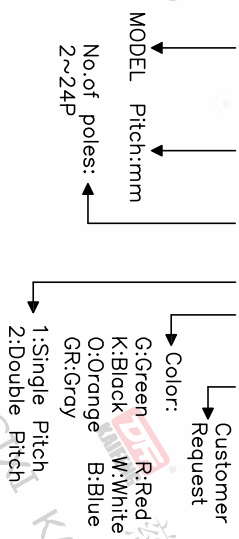

DF 慈溪市凯峰电子有限公司
CIXI KAIFENG ELECTRONICS CO.,LTD

TITLE: HB-951M-9.5-XXP-1X-PA
SERIES: HB-951M

